

K9 T 20 BS

CS Italia s.r.l.



Optional su richiesta info@carrellispeciali.it 

K9 T 20 BS

CS Italia s.r.l.

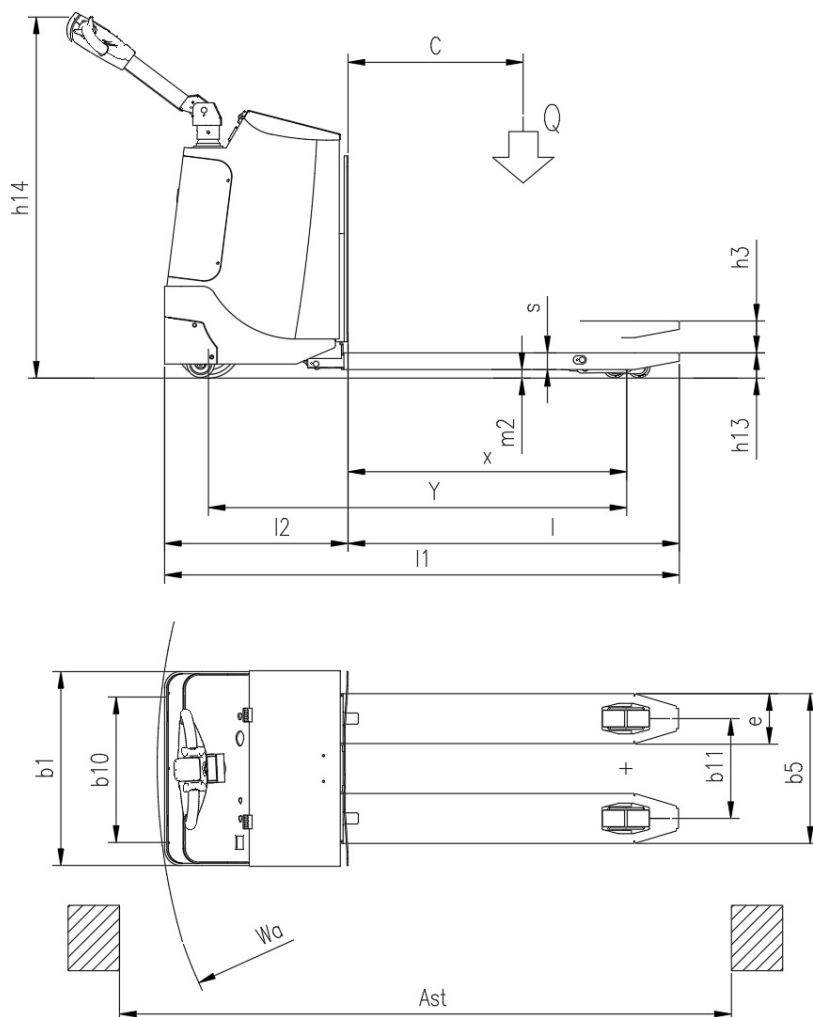

Illustrazioni e dati tecnici non sono impegnativi. Il costruttore si riserva il diritto di apportare modifiche senza preavviso.

Tipologia K9 T 20 BS

Categoria Acciaio Inox

General info	1.1	Manufacturer			CSI s.r.l.
	1.2	Model			K9 T 20 BS
	1.3	Drive			elettrico AC
	1.4	Operator type			a timone
	1.5	Load capacity	Q	t	2
	1.6	Load centre	c	mm	600
	1.8	Load distance to wheel axle	x	mm	1005
	1.9	Wheelbase	y	mm	1760
	Weights				
	2.1	Truck weight without battery		Kg	400
Wheels and chassis					
	3.1	Wheels			Poliuretano
	3.2	Wheels size front		mm	235x75
	3.3	Wheels size rear		mm	70x80
	3.4	Additional wheels size		mm	100X38
	3.5	Number of rear/front wheels (x = Traction wheel)			1x 1+1/2+2
	3.6	Front wheelbase	b10	mm	480
	3.7	Rear wheelbase	b11	mm	360
Dimensions					
	4.4	Lift height	h3	mm	115
	4.9	Height of tiller (min/max)	h14	mm	975/1535
	4.15	Height forks lowered	h13	mm	90
	4.19	Overall length	l1	mm	1850
	4.20	Length to face of forks	l2	mm	660
	4.21	Overall width	b1	mm	790
	4.22	Forks dimensions	s/e/l	mm	60/180/1190
	4.25	Overall forks width size	b5	mm	540
	4.31	Ground clearance		mm	30
	4.32	Distanza da piano di lavoro a inizio forca	m2	mm	30
	4.35	Turning radius	wa	mm	1690
Performance					
	5.1	Travel speed with/without load		Km/h	4/6
	5.2	Lifting speed with/without load		m/s	0.11/0.33
	5.3	Lowering speed with/without load		m/s	0.5/0.2
	5.8	Maximum gradeability with/without load		%	1/2
	5.10	Service brake			elettrico
Motor					
	6.1	Traction motor S2 60 min.		Kw	1.2
	6.2	Lift motor S3		Kw	2.2
	6.3	Battery			GEL BS
	6.4	Battery - voltage and nominal capacity		V/Ah	24V 190
	6.5	Battery weight		Kg	200
	Dim. batteria	Battery size		mm	660/260/570
Other					
	8.1	Traction control			proporzionale
	8.4	Noise level driver place			<70